

MASTERFLEX®

Masterflex® Single-Use Flow Sensor Systems

Disposable tubes for optimal contamination-free production

- No need for cleaning—decreases overall process time
- Responds quickly to changes in flow rate
- Save time—easily change out flow tubes within seconds
- PVDF tubes can be gamma irradiated for ultimate hygiene
- Automatic calibration eliminates the need to recalibrate every time you replace the tube
- Flow sensors are manufactured and tested under cleanroom conditions

The Masterflex single-use flow sensor system provides you with accuracy, reliability and repeatability of measurements. Measure all types of low viscosity, clear, opaque, neutral, corrosive, and aggressive liquids. Comprised of four components, customize the flow sensor to meet your needs. Simply select a flow tube holder, single-use turbine flow tubes, bar code scanner, and output.

Tube holder: Choose from tube holder, clip mount, clamp mount, and click housing. All allow for quick and easy flow tube replacement.

Flow tubes: All come precalibrated to one point and can be calibrated to 5 points (preorder). Each flow tube has an attached label that indicates the lot number, serial number, K-factor, and 2-D bar code with all the calibration data. Choose PVDF or PFA material.

Bar code scanner: Quickly read the bar code, making the calibration process unnecessary when exchanging a flow tube. Eliminate long downtimes and extra calibration while ensuring an accurate measurement with the bar code scanner.

Output: Choose from three options: digital-to-analog converter, panel-mount flow display with totalizer, and benchtop flow display with totalizer.



1-800-637-3739

Masterflex.com

Specifications

Accuracy: ±1% of reading at low flow

Repeatability: <0.15%

Fluid temperature: -20 to 80°C

Viscosity: 0.8 to 10 cSt

Liquid type: conductive or nonconductive fluids with no lenticular impurities

Sterilization:

PVDF: autoclave, EtO,
gamma irradiation

PFA: autoclave, EtO

Certifications*:

USP Class IV

BSE/TSE certified

*Certificates of compliance are available upon request.

Flow sensor systems

Holder type	Wetted parts	Flow range (L/min)	Tube connection	Max psi	Flow sensor (holder with tube)	Additional flow tubes (10/pk)
					Catalog number	Catalog number
Tube holder	PVDF/ruby	0.03 to 2	7 mm hose barb	362.6	MK-24507-02	MK-24507-14
		0.5 to 20	12 mm hose barb	290	MK-24507-03	MK-24507-15
	PVDF/sapphire	5 to 200	32 mm	145	MK-24507-04	MK-24507-16
Clip mount	PFA/ruby	0.06 to 2	7 mm hose barb	290	MK-24507-30	MK-24507-34
		0.5 to 20	12 mm hose barb	217.6	MK-24507-31	MK-24507-35
		1.5 to 40	½" BSP	145	MK-24507-01	MK-24507-13
	PVDF/ruby	0.03 to 2	7 mm hose barb	362.6	MK-24507-32	MK-24507-36
		0.5 to 20	12 mm hose barb	290	MK-24507-33	MK-24507-37
Clamp mount	PFA/ruby	0.06 to 2	7 mm hose barb	290	MK-24507-07	MK-24507-11
		0.5 to 20	12 mm hose barb	217.6	MK-24507-08	MK-24507-12
	PVDF/ruby	0.03 to 2	7 mm hose barb	362.6	MK-24507-09	MK-24507-14
		0.5 to 20	12 mm hose barb	290	MK-24507-10	MK-24507-15
Click housing	PFA/ruby	0.06 to 2	7 mm hose barb	290	MK-24507-05	MK-24507-11
		0.5 to 20	12 mm hose barb	217.6	MK-24507-06	MK-24507-12

Tube holder

Four screw holes for easy mounting on a surface or benchtop; the flow tube is held in place by closing the lid.



Clip mount holder

Lightweight with a flexible metal clip for use in a wide range of systems.

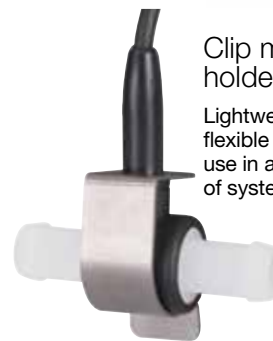

Accessories

MK-24507-27 Calibration certificate, single point, K-factor at 50% of flow range

MK-24507-28 Calibration certificate, K-factor at 5 points of flow range

Bar code scanner

Description	Output	Dimensions (W x H x D)	Power	Catalog number
K-factor bar code scanner for automatic calibration	5 to 24 V square wave	2.2" x 4.1" x 2.4" (5.6 x 10.5 x 6 cm)	5 to 24 VDC	MK-24507-18

Outputs

Description	Maximum input frequency	Output	Power	Catalog number
Digital-to-analog signal converter	5 kHz	0 to 10 V, 4 to 20 mA, 0 to 20 mA, 0 to 24 mA, 600 Hz, 1000 Hz, 6000 Hz, or 10,000 Hz	16 to 24 VDC	MK-24507-17
Flow display, desktop enclosure	10 kHz	Display with totalizer function	Internal lithium battery	MK-24507-25
Flow display, panel mount				MK-24507-26

Clamp mount holder

Compact and can be used on its own but also has a screw hole in the back for easy mounting.



Click housing

Small footprint and secures the flow tube in the housing. Ideal for tight hard-to-reach locations.



1-800-637-3739 | 1-847-381-7050

Masterflex.com